

2008-2009 Annual Report

November 1, 2009

To dare, to take risks, to bear uncertainty, to endure tension – these are the essence of the play spirit.

-Johan Huizinga, Homo Ludens, 1944

We play. Serious play, because a nation's future depends on it. The willingness to dare, to take risks, to bear uncertainty have been fundamental to our nation's birth and security. So many of our supporters make a living with and by the play spirit. Good education must be imbued with such play spirit. The play spirit allows people to learn, make friends, stay fit, and have agency in the world.

Academically, because we are not bound to teach to the test, students are guided in the true exploration of scientific, mathematical, historical, and literary skills and concepts. Rather than having students clapping and chanting in rows, we have them engage with each other and the material at hand. E.O Wilson's description of scientific reductionism could be a prescription for our teaching:

Let your mind travel the system, pose interesting questions about it. Break the question down and visualize the elements and questions it implies. Think out alternative conceivable answers. Phrase them so that a reasonable amount of evidence makes a clear-cut choice possible...search for another question...love the details, the feel of them, for their own sake...

What playful language this scientist crafts around this most structured of disciplines! Love the details? So somehow love enters back into education. Passion. Risk. Failure. Failure here can mean something has been fully ventured – not that all is lost on some high stakes test.

In athletics at EHS, students learn courage, temperance, endurance, and how to regulate cognitive and emotional impulses under the pressure of competition. In the process of sport and play, neural connections increase, as does capillary growth in the brain. Our students are on the athletic field of play four days of the week. And on these fields, they experience joy and transcendence. The stress of poverty and the attendant ills of noise and violence sever synaptic connections, yet exercise and play heal the brain and soothe the anxious mind.

Finally, in the arts, and our core art is drama, students learn to understand the human gesture, the human heart, and how to make them pulse as one. In drama, students memorize Shakespeare, Lincoln, the Preamble, and King – and they breathe life back into the intention of their words. It is called a *play* by Shakespeare, and the plays, even when comedy, are crafted with care.

At the end of all of this play, our graduates will act well, think well, and do good. I think our play spirit is what brings us together and why you have supported us in halcyon moments and in these times of economic challenge. We hope you remain at play with us.

Peace and always love,
Ivan

INSIDE THIS ISSUE:

Head of School Report	1	2008-2009 Achievements	4
Message From the Board	2	Capital Campaign Donors	6
About The East Harlem School	3	2008-2009 Giving Report	7



“I’ve always pushed my son to do better, and The East Harlem School aligned perfectly with my own values. The school instilled in my son the importance of rules and discipline. My son and I have both grown from the EHS experience, and I’ve learned so many new things about the potential of my own child. The School and I worked together, and they were the biggest help I could have possibly received in raising my son. The East Harlem School opens up a new world for so many children who have not had the opportunity to succeed. My only wish is that the school could have started in first grade.” -Kay Phillips, EHS ‘08 Parent

A MESSAGE FROM THE TRUSTEE CHAIR

Dear Friends and Supporters,

It has truly been a milestone year at The East Harlem School! We have held our Commencement ceremonies and greeted the first days of an academic year in our beautiful new building. As we near the anniversary of our December 2008 ribbon cutting celebration, we look back with gratitude on the depth of commitment that has brought The East Harlem School this far.

The remarkable façade that stands out on 103rd street is a physical reminder of The East Harlem School’s potential to change the landscape of urban education, and we are better positioned than ever before to share our philosophy with a wider—indeed national—audience. The new school allows us to accommodate up to 150 students. Our current student body is one hundred and thirty. Of course, with expanded operations comes an increased budget, and your support is more important now than ever. The 2008 Benefit honoring Mary Meeker and Bea Tompkins continued a trend of growing success, raising over \$1 million in one night. We are gratified by your part in achieving this goal, and hope that you will continue to endorse the mission of The East Harlem School in the coming year.

Thank you for being a part of The East Harlem School family.

Best wishes,

Diana D. Brooks
Chair, Board of Trustees

BOARD OF TRUSTEES

Diana D. Brooks, *Chair*

Debra Beard
 Jeffrey Brown
 David Carmel
 Stephanie Coleman
 Rebecca de Kertanguy
 Alice Geller
 Peter Gluck
 Mindy Grossman
 Neil Grossman
 Stephanie W. Guest
 David R. Haas
 Ivan M. Hageman
 Robert Heine
 Christopher Heinz
 Gregory Heyman
 Star Jones
 Kimberly Lumpkin
 Jonathan Patricof
 Robert Potter
 Carter Simonds
 Daniel Singer
 Beatrice Tompkins
 Michael Vranos
 Jeffrey Zukerman

FACULTY AND STAFF

Ivan M. Hageman
Co-Founder & Head of School

Donald Albert, *Building Superintendent*
 Kathleen Alexander, *High School Placement & Alumni Coordinator, Math Teacher*
 Michelle Anthony, *Cook*
 Caroline Chin, *Director of Finance & Operations*
 Abby Collier, *Humanities Teacher*
 Katherine Crotty, *Humanities Teacher*
 Tracy Eberhart, *Director of Development*
 Jennifer Feierman, *Development Associate*
 Lauren Frasco, *Program Associate, English Teacher*
 Maria Giarrizzo, *Drama Teacher*
 Courtney Knowlton, *Program Director, English Teacher*
 Nikrad Mahdi, *Math Teacher*
 Rosa Perez, *Cook*
 Jonathan Pryor, *Physical Education Teacher, Math Teacher*
 Kelsey Rennebohm, *Spanish Teacher*
 Spencer Robins, *Science Teacher*
 Chastidy Roman, *Program Assistant*
 Anne Ross, *Dean of Faculty & Staff, Math Teacher*
 Jonathan Salik, *Humanities Teacher*
 Elizabeth Yoselevsky, *Science Teacher*

ABOUT THE EAST HARLEM SCHOOL

THE MISSION: The East Harlem School is an independent middle school (grades 5-8) that educates students from low-income families in Harlem who exhibit the desire to rise to their academic potential. Through a rigorous and intensive curriculum emphasizing intellectual, moral, and kinesthetic development through interdisciplinary and cooperative learning, skill acquisition, and focused exploration, The East Harlem School instills confidence, skill, discipline, and moral accountability in its students. We are proud to state that our graduates finish high school and enroll in college at a rate that is more than double the national rate for Black and Latino students. In addition, many EHS graduates have completed high school at some of the most prestigious independent schools in the country including Phillips Exeter Academy, Deerfield Academy, Miss Porter's School, Kent School, Hotchkiss School, Taft School, and Loomis Chaffee.

HISTORY: Exodus House has played an important role in Harlem for over 40 years. Founded in 1963 by Reverend Dr. Lynn and Mrs. Leola Hageman as a rehabilitation center for drug addiction, Exodus House has been an anchoring institution in Harlem since its inception. Due to the critical concern for the welfare of the community's many at-risk children, Exodus House was converted in 1984 to an after-school and summer program.

Following in the Hagemans' footsteps, in the fall of 1993, the couple's sons, Hans and Ivan Hageman, opened an independent middle school featuring an extended school day and extended school year on the Exodus House site to address the needs of children and their families in the Harlem community.

The East Harlem School is chartered by the New York State Department of Education and is accredited by the Middle States Association of Colleges and Schools. The East Harlem School is a not-for-profit 501(c)(3) organization.

THE NEED: The East Harlem School is one of only a handful of schools in the city which focus solely on middle-school students. Between the ages of 10 and 13, children face critical milestones in their physical, emotional, mental, and social development, taking on more complex roles in their families and community and discovering and beginning to implement new analytical capabilities. Students in this crucial period either engage in or become alienated from learning. The children from Harlem are at particular risk during early adolescence, as many of the decisions made during this stage of development have long reaching social and economic effects.

SOLUTION: The School serves students from low-income families in grades 5-8, addressing the needs of the whole child by promoting intellectual, moral, aesthetic, and kinesthetic development. Through a rigorous curriculum that emphasizes interdisciplinary learning, skill acquisition, focused exploration, and cooperative learning, The East Harlem School instills confidence, skill, discipline, and moral accountability in its students. With the completion of an East Harlem School education, students are positioned and able to succeed in a variety of settings, while retaining the traditions and strengths of their own East Harlem community. The School has created, at scale, a model of early adolescent education that can and should be replicated by public or private schools in inner city communities throughout the nation.

2008-2009 ACHIEVEMENTS

The East Harlem School continued to strengthen its program by completing the following strategic objectives during the 2008-2009 fiscal year.

HIGHLIGHT: NEW BUILDING

Opened new school facility: In December, The East Harlem School opened the doors to the new \$12M school building at the original Exodus House site on 103rd Street. The new facility includes improved classrooms and science labs to enhance academic instruction, a multi-purpose outdoor play area, a gymnasium that can serve as auditorium for up to 300 people, art and drama rooms for creative development, an expanded library, a cafeteria that seats up to 150 people, and flexible space to allow EHS to meet as a full community.

PROGRAM

Strengthened curriculum and teaching: The East Harlem School successfully concluded the third year of expansion of its student body. This year, The East Harlem School completed its first school year with two classes in each grade, increasing our enrollment from 96 to 121 students. Five new teachers were hired and overall teaching staff was increased to accommodate the School's increased student body and preserve small class size. The East Harlem School continues to provide teachers with the training and support to strengthen their skills and enhance our curriculum. The School also made a strategic decision to begin offering drama to all grades, hiring a full-time drama teacher who has raised the level of our drama program. Each grade spent significant time preparing for the performance of a play. The public speaking and leadership skills taught in drama will further enable students to meet and communicate with a wide range of people.

Focus on Community, Civics, and World Issues: EHS continued the Weekly Speaker Series welcoming speakers representing a broad range of professions and experiences, such as Jonathan Alter, Newsweek editor and columnist; Robert Belinic, professional classical guitar player from Croatia; Robbie Barnett, professor of modern Tibetan studies at Columbia University; and Claude Mitchell, Director of Music for ESPN.

Targeted Developmental Guidance: EHS maintained weekly advisory and monthly gender groups, sessions in which students are divided by gender and discuss gender specific issues with a member of EHS faculty and staff. EHS continued to provide weekly reading groups for fifth and sixth grade students to provide opportunities to improve reading comprehension, discussion, and



Cast of the EHS 08-09 Drama Performance



A member of the EHS track team

AFTER SCHOOL PROGRAMS

Extracurricular and Enrichment Activities: The East Harlem School's after school program is a distinguishing element of the School's work. By engaging students in stimulating and challenging academic, artistic, and athletic activities during the afternoon, students develop a passion for pursuits beyond the classroom. For the second year in a row, EHS has participated in a Model United Nations program, representing the countries of Mexico and Jordan at the Model UN Conference at the United Nations in New York City. Additionally, East Harlem School students continued to support neighborhood organizations such as East River Family Center. The School's tutoring program has expanded to include volunteers from distinguished high schools such as Horace Mann School, Trinity School, and Dalton School. For the fourth consecutive year, EHS's sixth grade class participated in "Cornell Kids," a medical research and mentoring

program offered through New York-Presbyterian Hospital and Cornell University. Additional offerings included Yoga Club, Capoeira Club, Art Club, Poetry Club, and Dance Club.

Expanded Athletics Program: A full-time Physical Education teacher was hired this year, which allowed the school to offer gym four days a week now instead of three and increased the amount of focused exercise our students receive each week. We now separate our 5th and 6th graders from our 7th and 8th graders for sports. The 7th and 8th graders are able to participate in competitive sports teams with tryouts, daily practices, and games against other schools. The 5th and 6th graders have gym built into their daily schedule and are able to focus on learning the basics of fitness, coordination, and competitive sports. The curriculum has focused not only on physical fitness, but also on sportsmanship and teamwork. The School continues to offer lacrosse, track, soccer, and swimming.



Students performing a dance piece as part of the National Dance Institute workshop

Saturday School: This year, we added an optional Saturday School program for all EHS students. The program began in January, and we were able to offer two 8-week sessions of Saturday School. The program lasts three hours every Saturday morning, and the students spend half the time working on their homework and on skill-building activities with a tutor and the other half taking either a sports class or an art class. More than half of our students participated in this program.

SUMMER PROGRAM

Expanded summer program: This year’s summer program centered around the theme of courage. To explore this theme each grade read a different novel: in 5th grade *Tuck Everlasting*; in 6th grade *Hatchet*; in 7th grade *Night*; and in 8th grade *The Things They Carried*. In addition to attending the summer session, many of our students participated in camps or academic programs. This year, we leveraged over \$25,000 in scholarship money for our students to attend these programs.

ALUMNI PROGRAM

Improved and strengthened the alumni program: The EHS alumni program serves all of our alumni in high school and college by providing summer fellowships for community service, assistance with the college application process, tutoring, counseling, life-skills workshops, and internships. All alumni in high school were visited by a member of the



Students at the 2008 Fall Benefit

EHS staff at their independent, public, and parochial schools. All juniors and seniors were contacted and assisted with the college application process, which included speaking with college counselors at each high school, writing letters of recommendation, and taking alumni on college campus visits. We continued to offer the Brooks Fellowships for Community Service, which provides stipends for East Harlem School alumni who work in summer internships at non-profit and community-based organizations.

TRUSTEE AND YOUNG VOLUNTEERS COMMITTEE

Improved and strengthened the efforts of the school: EHS continued to strengthen the Board of Trustees with the addition of two new members, Alice Geller and Peter Gluck. The Young Volunteers Committee continues to support Super Saturday events, including our annual Field Day, mock interviews for eighth grade students, and ice skating in Central Park. The YVC and the development team worked together closely to plan and execute the School’s annual Spring Poetry Slam.

PARTNERING ORGANIZATIONS
Booker T. Washington Center
East River Transitional Housing Facility
Polo Ralph Lauren
National Dance Institute
United Nations Association of the United States of America’s Global Classrooms
Princeton University Class of 69
Asphalt Green Waterproofing Program
The Mountain Institute
Brearley Summer Start
Westover School Summer Session
The Great Books Program
The Boys Club
Little Sisters of the Assumption
East Harlem Center for Asthma Excellence
Cornell University’s Cornell Kids Program
Weil Cornell Medical Center
Christodora Manice Education Center
Fieldstone Middle School
Regis Christian Service
The Downtown Boathouse
All Souls Soup Kitchen
The Metropolitan Museum of Art
Food Bank of New York
Hale House
Carter Burden Center for the Aging
West End Intergenerational Residences
CityLAX
Independent School Athletic League
Camp Kabeyun
Cornell University Future Stars Lacrosse Camp
The African Film Festival
Barney’s New York
Legal Outreach
Summer Search
Nelson Mandela Foundation

Capital Campaign Commitments as of August 31, 2009

Anonymous (2)	The Hillman Company	Beth Ratcliffe
Ernest and Kathleen M. Abrahamson	Laura Hoffman	Ethan and Elly Rice
Charles and Deborah Adelman	The Hollyhock Foundation	Donna Rich
Altman Foundation	Murray and Louise Hood	Mike Richman and Sandy Fleischman
Mr. and Mrs. Charles S. Anderson	Michael Huber	River Rock Foundation
Regina Gilgan and Marko Andrus	Andrew Hughes	The Robertson Foundation
George and Anne Baker	Mr. and Mrs. John Hyland	Spencer and Sarah Robertson
Lisa Underwood and Michael G. Barnes	Mort and Chris Hyman	Robin Hood Foundation
Mr. and Mrs. Anson McC. Beard, Jr.	Barbara Welles Iler	Gary and Maureen Sagui
Michael and Eryn Bingle	Arif Inayatullah	The Margaret Ann Chisholm Charitable Trust
Tommy and Tantivy Bostwick	A.C. Israel Foundation, Inc.	Adam Salky
Paul and Alicia Brill	Mr. and Mrs. Mitchell Jacobs	Marisa Saur
Mattie Brine	Ann Dexter-Jones	Diane Schneider
Sarah Brokaw	Irene and Rita Joyce	Jolie Schoeffer
Diana D. and Michael C. Brooks	Marina and Stephen Kaufman	Jonathan and Kimberly Schulhof
Louise and Arde Bulova Fund	William S. Keating	Clarence B. Schwab and Pamela Haas Schwab
Rob and Meg Campbell	Teresa Heinz Kerry	Russell T. Shepard
Beth Carey-Niebuhr	Knock Knock Productions	John and Goldie Siffert
Carson Family Charitable Trust	Philip Korot	Carter and Talbott Simonds
Lewis Chewing	Lew and Judy Kramer	Dan Singer and Catherine Havemeyer
David Clarke	Jerome Kurtz and Eileen Rosenau	Joy Singer
Ed Cleaver	Leslie Barnett and David Laufer	Richard Singer
The Chase and Stephanie Coleman Foundation	The Lehman Brothers Foundation	Hope G. Solinger
Mr. and Mrs. C. Payson Coleman, Jr.	Scott A. Levine and Alice Geller	Connie Sopic
Mr. and Mrs. Charles P. Coleman, III	James and Carol Lister	Drs. Mark Sorenson and Meriamne Singer
Richard and Greta Weil Conway	John Locker	Loretta, Dennis and Madeline Spates
Bruce Crain	Lopez Low Foundation	Starr Foundation
Christina Dennis	Teresa Maffucci	Lary and Jacqueline P. Stromfeld
Barbara and Chris Dixon	Jerome C. Marcus	Kelly and Jay Sugarman
Marianne K. Dolan	Shauna Marshall	Chris Swon
Cissi Douglas	Kevin A. McDermott	Table 34
Nancy and Blue Eaves	The McGowan Family	Abigail Talcott and Patrick Watson
David and Frances Eberhart	Deborah McManus	Jill Tamucci
J. Mark Edwards	Mary Meeker	Peter and Coralyn Taylor
Christopher Einhorn	Mark and Jennifer Megalli	Dave and Karin Thomas
Brian Frank and Lauren Reiss	Eileen and Liad Meidar	Mr. and Mrs. Nathan C. Thorne
Fremont Group Foundation	Robert Meringolo	James and Lorayne D. Thornton Foundation
James Frischling	Dennis Meyers	Evonne Jennings Tolbert, Esq.
Sarah Gallagher	Mr. and Mrs. William Michaelcheck	Walter Tomenson, III and Marisa Saur
Louis V. Gerstner, Jr. Foundation	Dara Mitchell and Mike Offit	Beatrice G. Tompkins
Barbara P. Gimbel	Mark Morrill and Marilyn Greenberg	Michael R. and Lisa Treanor
Brooke P. Goodchild	Margaret Morton	Thelma Turkel
The Russell Grinnell Memorial Trust	Akshay Murthy	Sarah Varet
Neil and Mindy Grossman	Laurie Gene Mygatt	Paul and Andrea Lynn Vizcarrondo, Jr.
Phoebe Gubelmann	Laurie Gene Mygatt	Michael and Anna Vranos
Stephanie W. Guest	Ellen and George Needham	Bill Vratto
David and Susan Haas	Leslie and Mitchell Nelson	Sandy and Patsy Warner
Jonathan and Lisa Haas	Network Outsource, Inc.	Janice and Christopher Williams
DJ and Barbara Haley	Edward and Amanda Oakley	Grant F. Winthrop
James and Gayle Halperin Foundation	Jeffrey L. Orridge and Carly Gleser	Dan Wisniewski
Eric Hamilton	Paradigm Health	Stacie Wong
Charles Hayden Foundation	Cheryl Pascual	Judy Zankel
David Haynie	Jonathan and Victoria Patricof	Jeffrey and Kathryn Zukerman
Robert and Mary Grace Heine	Sarah Payne	
Heinz Family Foundation	Alison B W Pena	
Andre T. Heinz	Barnett Phillips, IV	
Sasha and Christopher Heinz	Ron and Emily Portnoy	
Mr. and Mrs. Gregory P. Heyman	Bob Potter and Anne Patterson	
Kiwi and Landon Hilliard	Prince Charitable Trusts	
	Courtney Quick	
	Warren Rabin	

2008-2009 Capital Campaign and Annual Giving

EHS is an independent school and does not receive any government funding. The School received donations from the following individuals, foundations, and corporations enabling us to provide a year-round and extended school day (8:00AM - 5:00PM) to our students, to offer counseling and support to our alumni in high school and college, and to execute the School's expansion. The East Harlem School would like to thank the following people for supporting our work with gifts received between September 1, 2008 and August 31, 2009, the School's fiscal year.

Super Benefactor

(\$500,000+)

Robert and Mary Grace Heine
Robin Hood Foundation

Benefactor

(\$50,000 - 499,999)

Anonymous
Altman Foundation
Diana D. and Michael C. Brooks
Laura M. and Peter T. Grauer
Foundation
The Russell Grinnell Memorial Trust
Heinz Family Foundation
Lopez Low Foundation
Polo Ralph Lauren Foundation
Mr. and Mrs. Nathan C. Thorne
Tiger Foundation
Tsunami Foundation: Anson and
Debra Beard, Jr. and Family

Champion

(\$20,000 - 49,999)

Ernest and Kathleen M. Abrahamson
David M. Beirne
Carson Family Charitable Trust
Solina Chau
The Chase and Stephanie Coleman
Foundation
Mr. and Mrs. Charles P. Coleman, III
Mr. and Mrs. Ernesto Cruz
Christina Dennis
The Andrew K. Dwyer Foundation
David and Frances Eberhart
Fox Broadcasting Company
French American Charitable Trust
David and Susan Haas
Mr. and Mrs. Gregory P. Heyman
The Hollyhock Foundation
Scott A. Levine and Alice Geller
Roger Low
Mary Meeker
Moon Capital Management, LP

Anthony Paduano and Ruth Porat

Jonathan and Victoria Patricof

The Robertson Foundation

The Margaret Ann Chisholm

Charitable Trust

Russell T. Shepard

Carter and Talbott Simonds

Dan Singer and Catherine Havemeyer

Talbott and Carter Simonds

Foundation

Trustees Circle

(\$10,000 - 19,000)

Anonymous
Constance L. Breuer Charitable Lead
Trust
Louise and Arde Bulova Fund
Bennett and Brenda Carroccio
Silas Chou
Cornell University Foundation
Wendy Mackenzie and Alexander
Cortesi
Loic and Rebecca de Kertanguy
Marianne K. Dolan
The Max and Victoria Dreyfus
Foundation, Inc.
Mr. and Mrs. Andrew T. Dwyer
Neil and Mindy Grossman
Stephanie W. Guest
The Marc Haas Foundation
Sasha and Christopher Heinz
Kiwi and Landon Hilliard
ITG
David Kunz
Roger and Cynthia Lang
Sid and Ruth Lapidus
Morgan Stanley
Paul D. Shurgot Foundation, Inc.
Nancy Peretsman and Robert Scully
Mr. and Mrs. Ram Shriram
Gregory Thomaier
Heidi Ueberroth
Mr. and Mrs. Bronson Van Wyck
Michael and Anna Vranos

Michael and Carol Weisman

Meg Whitman

Jeffrey and Kathryn Zukerman

Dean's List

(\$5,000 - 9,999)

Charles and Deborah Adelman
Mr. and Mrs. Anson McC. Beard, Jr.
BJ Foundation
Blue Ridge Capital
Brown Hill Development LLC
Jeffrey Brown
Mr. and Mrs. Harry Burn
Paul and Martha Chamberlain
Citigroup
Jeanne Donovan Fisher
Paul Francis and Titia Hulst
GE Foundation
Michael Grimes
Bill and Anne Harrison
James N. Hauslein
Harriet Heyman and Michael Moritz
Ann Jackson
The Lautenberg Foundation
Douglas Liebhafsky and Wendy
Gimbel
Jerome C. Marcus
Anonymous
Colin and Dee McKechnie
Merck Partnership for Giving
David A. and Mildred H. Morse
Charitable Trust
Ted Muehling
Robert Rauch
John and Rachel Rodin
Sidney J. Weinberg, Jr. Foundation
Mitchell Silverman
Thendara Foundation
Sandy and Patsy Warner

Scholarship

(\$1,000 - 4,999)

Aerofox LLC
Magnus Ahlquist

2008-2009 Giving Report: Cash or securities gifts received between September 1, 2008 and August 31, 2009

Elaine Alexander	Mr. and Mrs. David Hathaway	Ron and Emily Portnoy
Krista and Devon Archer	John Heinz	Megan Quinn
Asier Artaechevarria	Mr. and Mrs. William W. Helman	Ramapo Trust
Mr. and Mrs. John Bachofen von Echt	John M. Hennessy	Alita Davis Reed
Mr. and Mrs. Frank Baker	Joanne and Adam Heyman	Michael Ro
Amika Banfield	Elsie H. Hillman Foundation	Mr. and Mrs. Stephen Roach
Gloria and Roy Benjamin	Doug Hirsch and Holly Andersen	Mr. and Mrs. Eric Ryan
Tom and Leah Bernthal	Mr. and Mrs. Franklin W. Hobbs	Patrick and Susan Sanaghan
Lisa Blau	Murray and Louise Hood	Jonathan and Kimberly Schulhof
Robert Brenner	Huron Consulting Services LLC	Thomas and Barbara Schweizer
Paul and Alicia Brill	Jonathan and Joy Ingham	Daniel Senor
Brooks Foundation, Linda and Tony Brooks	A.C. Israel Foundation, Inc.	Mr. and Mrs. Alfred Shuman
Hope Brown	Heather James	Boaz Sidikaro
Richard Brown	Mitch Jennings and Beth Dater	John and Goldie Siffert
Anonymous	David Joseph	The William E. Simon Foundation
Bo Brownstein	Tory and Gibb Kane	J.L.H. Simonds
Kirsten and David Carmel	Karin Katz	Kelly and Jay Sugarman
Susan and Alex Casdin	Marina and Stephen Kaufman	Mr. Paul J. Taubman
Mr. and Mrs. C. Payson Coleman, Jr.	Mr. and Mrs. Dennis Keller	The Sexton Family Foundation
Richard T. Collier	Mr. and Mrs. Thomas Ketchum	Lyle Tick
Richard and Greta Weil Conway	Lisa and Oliver Knowlton	John and Joan Toffolon, Jr.
Corcoran Group	Philip Korot	Beatrice G. Tompkins
Joy Covey	Lew and Judy Kramer	Will Tracy and Ellen Carucci
Crane Fund for Widows and Children	Ben and Bonnie Krupinski	John B. and Louisa S. Troubh
Alex Dimitrief	Thomas Lally	Yossi Vardi
Disney VoluntEARS Community Fund	Robert Leask	Verizon
Disney Worldwide Outreach	Lilah Hilliard Fisher Foundation	John S. Wadsworth, Jr.
Richard Edelman	James and Carol Lister	Alexander G. Warner
Stacey Bendet and Eric Eisner	The Margaret and Daniel Loeb - Third Point Foundation	Mr. and Mrs. Weinberg
Emily Fisher and John Alexander	John Mack	Josh Wolfe and Lauren Taylor Wolfe
Mr. Brian Fitzgerald	Stephen Mack and Kelly Kennedy Mack	Taunya Woo
Mr. and Mrs. Jonathan and Marie Fogel	Mr. and Mrs. Steven Marks	Earle and Beth Yaffa
Peter Friedland	Jessica Marshall	James Yenicag
James Frischling	Rocco and Roxanne Martino	Mr. and Mrs. Andrew Zaro
Mr. and Mrs. Edouard Gerschel	Colin and Rebekah McCabe	The Zimmerman Foundation
Derivatives Consulting Group LLC	Katherine and David McCallum	
Gil Koenigsberg	John and Elly McKenna	Sponsor
Barbara P. Gimbel	Richard Meeker	(\$500 - 999)
Mr. and Mrs. James Gorman	Keith Meister	Jesse Angelo
Mary A. and Thomas F. Grasselli	Mr. and Mrs. Corey Metz	Mr. and Mrs. Thomas C. Barry
Endowment Foundation	Joan Nicolais	Gotham, Inc.
Sloan and David Greenspan	Mark Norell and Vivian Pan	Mr. and Mrs. Rodney Berens
Josh and Shoshanna Gruss	Alan and Susan Patricof	Mark Black
Gubelmann Family Foundation, Inc.	Dick and Mary Payne	Amy Monderow
Greta Gunnarsdottir	Mr. and Mrs. Joseph Perella	Michael Borkow
	Randall Phelps and Pamela Daley	Dr. Steven M. Butensky
	Lucy and Brian Pitz	Charles and Margaret Charnas
		Shuvro Chowdhury
		Errol and Gladys Cook

2008-2009 Giving Report: Cash or securities gifts received between September 1, 2008 and August 31, 2009

Kelly and Andrew Dahle	Laurie Gene Mygatt	Raleigh Anne Blank
Willis and Peggy DeLaCour	Steve O. Newhouse	Ernest Bogen
Mr. and Mrs. Daniel Driscoll	Bruce, Nicole, and Michael Paisner	Callae Brownstein
Graham Duncan	Doris and Martin Payson	Nicholas Burger and Georgia Hanford Burger
Danielle Englehardt	Sandra and Norman Pessin	Kenneth Burke
Stuart J. Epstein	Peter L. Gluck and Partners, Architects	Anne Burns
Dana Evan	Joan M. and Charles A. Platt	Chris and Robert Butler
Mr. and Mrs. Joshua Ezrin	Bob Potter and Anne Patterson	Lise Buyer
Mark and Laura Fishman	Isabel R. Potter	Rob and Meg Campbell
Jay and Jenny Galluzzo	Stephen Prince	Kenneth and Nancy Carlson
Howard and Nancy Ganz	Ashely and Robert Reid	Peter W. Carmel, MD
Maria Ginzburg and Marc Sgaraglino	Zebediah Rice	Bruce Crain
Matthew and Kathy Glowski	Joseph Rogers	Michael Crimmins
Richard Goldstein	Jane Rosenthal and Craig Hatkoff	Tony Cuomo
Bridget Goodbody	Marie Rossi	Susan Decker
Mr. and Mrs. Peter Goulding	Carol T. Ruderman	Peter and Whitney Donhauser
Mr. and Mrs. Bruce M. Greenwald	Cameron and Jessica Russell	Simon Doonan
Stewart Gross and Lois Perelson- Gross	Kendrick Sadler	Mr. and Mrs. Wolcott B. Dunham
Mr. and Mrs. Andrew Guevara	Mr. and Mrs. Williams Salisbury	David O. Earls
DJ and Barbara Haley	Connor Schell	Christopher Einhorn
Carla Harris	Jolie Schoeffer	Lindsay Failing
Andre T. Heinz	Sarah Scrymser	Ron Feinstein
Emily Hellstrom and John Marino	Ellen Siminoff	Barbara Jeanne Fields
Jason Hirschhorn	Henry John Simonds	Darrell Fields
Benjamin Huneke	Mr. and Mrs. George Bundy Smith	Alan J. and Susan A. Furst
David and Alice Hunt	Drs. Mark Sorenson and Meriamne Singer	Mr. and Mrs. William Garrison
Mr. and Mrs. John Hyland	Bonnie and Tom Strauss	Louis and Rose Germano
Steven Jaffe	Mary Tanaka	Rowene Weems Giarrizzo
Rory and David Jones	Charles and Karin Thomas	Godfrey R. Gill
Dana Jones	Eurel Tobias	Alex Gobo
Star Jones	Joseph Varet	John S. and Gwen Grotta
Dr. and Mrs. Walter B. Jones	Arthur Whitman	Jonathan and Lisa Haas
Jill and Harry Kargman	Janice and Christopher Williams	Carl and Fran Harnick
Karen and Thomas Keating	Scott and Linden Wise	Max Herrnstein
Flavia Kelson	Monica and Jerome Wood	Douglas Heyman
David Kirsch	Jon Ylvisaker and Eleanor Lembo	Ashley Hobbs
Paul and Mary L. Lambert		Adam Holt
David Lauren	Patron	Jamie and Jonathan Horowitz
Peter and Gretchen Lengyel	(\$250 - 499)	Michael Jaffe
William Ludgate	Karl Ackermann	Dr. Patricia Jordan
Kimberley Lumpkin	Iris and Nathan Adler	Mr. and Mrs. Adrian Keevil
Rush and Brooke McCloy	Carol R. Angell	Amanda Kirby
Matthew V. Merola	Jessica Aronin and Justin Leitner	Werner and Sarah-Ann Kramarsky
Vanessa and Al Merrin	Neil and Torrey Baron	Ann and Steve Leber
Lester and Eleanor Migdal	Sharon Bazbaz	Mitchell Levine
Bonnie Morrison	Garrick D. Bernstein	Kenneth R. and Grace W. Logan
Doris T. Muir	Cathleen Black	Sharon Lynch
Henry S. Myers		Duffy Macri

2008-2009 Giving Report: Cash or securities gifts received between September 1, 2008 and August 31, 2009

Valerie Malter	David Barry	Joel Epstein
Margaret Mintz and John Birdsall	Nicole Barsamian	Alex Faherty
Gillian Munson	Therese Bateman	Michael Faherty
Lynn Nesbit	Meredith Bawden	Michael and Annette Feierman
Jennifer Lowe Noble	Frank Becker	Katie Firth
Talila O'Higgins	Brian Belsky	Nicole Fonarow
Margaret Osius	Pico Ben-Amotz	Jennifer Fowler
John J. Peterson	Dennis Berman	P. Wayne and Mary L. Frey
Mason Pettit and Sara Van Beckum	Vivian Bernal	Jessica Friedman
Mr. and Mrs. Howard Phipps	Anna and Ben Bernanke	Linda Fung
Brent and Susannah Prill	L. Price Blackford	Mr. and Mrs. John W. Geary III
Mr. and Mrs. Joseph Rault	Blithe S. Bock	Kathleen Gerdes
Dr. and Mrs. Thomas Robinson	Penelope Bodry-Sanders and	Michael J. Gillespie and Lauren C.
William Rosenwald Family Fund, Inc.	Mackarness Goode	Glant
Douglas Ross and Jerilynn Radcliffe	Lowell Boyers	Claire Gilman
Andrew Rossi	James Bundy	Priscilla Gilman
Jessica Russell	Christopher and Elizabeth Burn	Susanna Aaron and Gary Ginsberg
Jamie Schiff and Tyler Schiff	Eben Burr	Christopher Greene
Mr. and Mrs. Richard Schneidman	Sarah and Charles Butler	Caroline Greenwald
Gillian Segal	Caren Byrd	Victoria Guest
Mr. and Mrs. Andrew Shure	Meredith Callahan	Kitty Hall
Adam Sloan	Betty Campbell-Adams	Megan Hallan
Andrew Slutsky	Michael Canarick	Melinda P. Hamilton
Wayne Smith	Maria Carlucci	Eden Hammond
Margaret Stevens	Mark A. Chandler	Dwane Hawkins
Tracy Straus	Katherine Chang	Ahvie Herskowitz
Michael and Cindy Tannenbaum	Chanda and Matthew Chapin	Mr. and Mrs. S. Mark Hinckley
Dr. Butch and Ellen Thomas	Anna Chapman	J. Catherine Hirsch
Mary and Bernard Tompkins	Lynne Chase	Jane T. Holmes
Ellen Wagner	Charles Clough	Timothy Horsburgh
Anne Waterman	Scott Cohen	Phyllis Huang
Andrew Weinberg	Theresa Condor and Remi Hoki	Sam Jackson
Mr. and Mrs. J.D. White	Kathleen Crandall	Martha Jacobs
Ingrid Wong and Russell DeLaCour	Bonnie Crellin	Jessie Jenkins
Dr. and Mrs. John Xethalis	Anne Crisafulli	Catherine Jensen
	Ernesto and Austen Cruz	Christian M. Jensen
	Edward George Cunningham	James and Pat Johnson
	Ron and Judy Davenport	Wayne and Margaret Kaltenberger
	Patricia Davidson	Tonia Kaminsky
	Stephen C. Demijian	Mr. and Mrs. Gordon Kaye
	Ilene Deutsch	Bruce Longley
	Camille Douglas	S. Dewey and Anne Keesler
	Debbie Dunlap Kenny	Eileen Kelly
	Grace Eagar	Chris Kempner
	Mr. and Mrs. William Eagar	Joshua Kennedy
	Frederick Eberstadt	Colleen Kenny
	Reverend Norman C. Eddy	Patricia Kim
	Elly M. Eisenberg	Scott Kimmel
	Jennifer and Jeff English	Knock Knock Productions

Friend*(Up to \$249)*

Anonymous
Crysell Allen
Chris Allwin
Carl W. Andrews
Lauren Angelilli
Jill Apple
Susan and Ric Apter
Bryan Austin
Melissa and Edward Barnes
Nell Barnes
Sandra Baron-Alves

2008-2009 Giving Report: Cash or securities gifts received between September 1, 2008 and August 31, 2009

Courtney Knowlton
 Dr. and Mrs. Ira J. Laufer
 Mrs. Wendy Vanderbilt Lehman
 Jamie and Michael Leonhart
 Dominique Levy
 Casey Littlefiend
 Margaret and Daniel
 Robert and Frances Low
 Winifred Mabley
 Ken Mackenzie
 Ann MacRae
 Gloria Macri and Lorraine Gattie
 Teresa Maffucci
 Linda Malamy
 Paul and Annette Marcus
 Andrew McCann
 Jonathan F. McKeage
 Lisa McKenna
 Olga Melbardis
 Kirsten Moburg
 Natalie Moore
 Corey Mulloy
 Lois Murray
 Akshay Murthy
 Marya Myers
 Maty Ndiaye
 Dana and Brad Needleman
 Mary Nelson
 Jeffrey L. Orridge and Carly Gleser
 Jacynth P. Orridge
 Mr. and Mrs. Samuel P. Peabody
 Alison B W Pena
 Vi Petzinger
 Sarah Plaskitt
 Liz and Martin Poole
 Richard Portogallo
 Jeff Preston
 Michael Provenz
 William Pryor
 Amy Raudenbush
 Anne Reilly
 Nora Jordan and Allen Reiser
 Linda Riefler
 Nikki Riegler
 Timothy E. Rogers and Kate A.
 Wallace Rogers
 Jeff Rose and Rosina Rubin
 Carly and Dan Rosenberg
 Paige Ruane

Joanne Ruelos
 Win Ruml
 Joan S. Russo
 Sarah Scalia
 Larry and Marietta Schiff
 Gordon and Laura Schmidt
 H. Richard Schumacher
 Sebastian Stubbe
 Nick Shalek
 Ian Shand
 Sean Shapiro
 Joy Singer
 Mr. and Ms. Matt Slater
 Jonathan E. Smith
 Linda K. Smith
 Sheila and Nicholas Smithie
 Julie Sootin
 William and Maureen Stein
 Olivia Stephens
 Theodore Svoronos
 Dr. Daniel and Alice Swistel
 Catherine Talabac
 Target
 Khalilah M. Taylor

Jake Taylor
 Mr. and Mrs. Laverne Thompkins
 Allison Tick
 Lynette Tompkins
 Tina Trinh
 Oscar Tucci
 Cecile Urrea
 Sara Van Beckum
 John Vlahoplus and Uma
 Muthuchidambaram
 Niurka Wagner
 Gabriel Wallach
 Dr. and Mrs. Stephen F. Wang
 Conetta Washington
 Burton and Norma Wasserman
 Karen Wells
 Douglas Wilcock and Mary Haynes
 Wilcock
 Art Winston
 Wren W. Wirth
 Workhouse Publicity, Inc.
 Nancy Ye
 Remi Yong
 David Yoon



The East Harlem School

A T E X O D U S H O U S E

Exodus School
**The East Harlem School
at Exodus House**
309 East 103th Street
New York, NY 10029
www.eastharlemschool.org

T: 212.876.8775
F: 212.876.8776
E: info@eastharlemschool.org

The East Harlem School at Exodus House is a 501(c)(3) not-for-profit organization. Support from our donors enables us to provide a distinctive, comprehensive education to middle school students. With your assistance, we can continue to provide an exceptional learning community to our growing number of students, to offer academic counseling and guidance to our alumni, and to execute the School's expansion.

Please make your tax-deductible gift to the EHS Annual Campaign no later than the end of our fiscal year on August 31, 2010. Gifts made between September 1, 2009 and August 31, 2010 will be acknowledged in our Annual Report to be released in October, 2010. In order to make your contribution, please contact Tracy Eberhart, Director of Development, at (212) 876-8775 x304, or visit our website: www.eastharlemschool.org.

Can we count on your support today?
Thank you!

Every effort was made to ensure that these listings are accurate, complete, and reflect the wishes of the individual donors.

If there is an inadvertent error or omission, please accept our apologies and notify:

Tracy Eberhart
Director of Development
teberhart@eastharlemschool.org

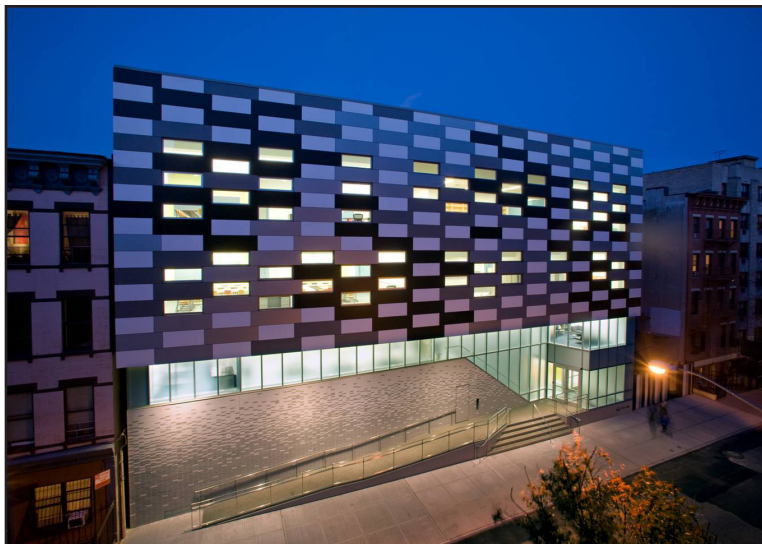

Selected photos courtesy of
Michael Priest Photography and Peter Gluck Architects